

Description

The Valve Lockout Device is used to mechanically lock a pressurized valve to ensure that it remains inoperable while technicians carry out maintenance work. The Lockout Device is attached to the operational components of the heavy duty valve to prevent the valve from changing position. Valve lockouts help prevent potentially harmful accidents during maintenance or repairs and allow workers to close off or isolate energy sources such as hydraulic pressure and fluids. This specific lockout device is designed for use on a heavy duty valve to stop any rotation of the handle.

Caution: The field installation recommendations are general and it is the responsibility of the end user to assure that installation is in accordance with local requirements and ASME practices. Neither Barksdale nor its agents assume any liability for lockout devices improperly installed and maintained.

Field Installation:

1. Tools Required:

- Torque wrench
- Open end wrench 15/16 inch

2. Procedures:

- Use open end wrench to remove the two bolts (6) and nuts (12) on the side with the detent holes
- Install the bracket (7) on the housing (9)
- Retighten the bolts and nuts with torque wrench to:
 - 180 in³/lbs for 3/8" and 1/2"
 - 480 in³/lbs for 3/4" and 1"
- Remove all handle components (1, 2, 3, 4) on top of the valve to access the detent disc
- Discard the detent disc. Install the new detent disc (5)
- Re-install all handle components on top of the valve
- Tighten the handle nut (1)

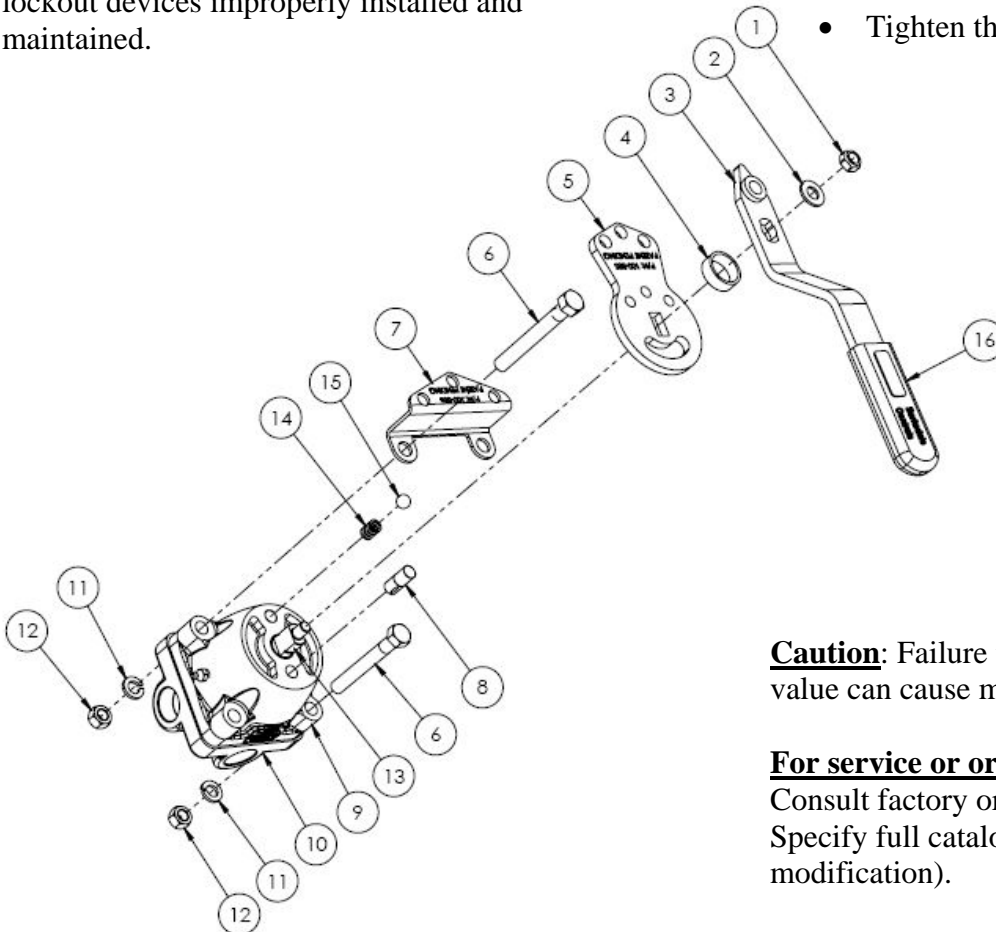

Caution: Failure to torque nut (12) to specified value can cause malfunction or failure of valve.

For service or ordering information

Consult factory or authorized factory representative. Specify full catalog number (with optional modification).